

# Original BMW Accessory. Installation Instructions.



## Retrofit M aerodynamic package BMW 3 Series Saloon (E90) BMW 3 Series Touring (E91)

<b>Retrofit kit No.:</b>	51 95 0 403 533	51 95 0 403 534
	51 95 0 409 692	51 95 0 409 693
	51 95 0 409 694	51 95 0 409 695
	51 95 0 409 696	51 95 0 409 701
	51 95 0 409 702	51 95 0 409 703
	51 95 0 409 704	51 95 0 409 705
	51 95 0 409 709	51 95 0 409 710
	51 95 0 409 711	51 95 0 409 712
	51 95 0 409 713	51 95 0 409 714
	51 95 0 409 759	51 95 0 409 760
	51 95 0 409 761	51 95 0 409 762
	51 95 0 409 763	51 95 0 409 764

### Installation time

The installation time is 3.5 – 4.0 hours, but this may vary depending on the condition of the car and the equipment in it.

The adjustment or installation of components for options SA 502, SA 507, SA 508 or SA 520 is not included in the specified installation time and must be charged separately on the basis of what is actually being installed (see KSD for installation time and further details).

### Important information

These installation instructions are primarily designed for use within the BMW dealership organisation and by authorised BMW service companies.

In any event the target group for these installation instructions is specialist personnel trained on BMW cars with the appropriate specialist knowledge.

All work must be completed using the latest BMW repair manuals, circuit diagrams, servicing manuals and work instructions in a rational order using the prescribed tools (special tools) and observing current health and safety regulations.

**To avoid unnecessary extra work and/or costs, if any installation or function problems occur, after a brief troubleshooting session (approx. 0.5 hours), contact the following:**

- 1. Either your national sales company or your regional office or**
- 2. The Support team via the Aftersales Assistance Portal (ASAP) using the optional technical parts support application.**

**Quote the VIN and the part number of the retrofit kit and provide a detailed description of the problem.**

Do not archive the hard copy of these installation instructions since daily updates are made by ASAP.

See ASAP for details of the pictograms.

Pictograms



Denotes instructions that draw your attention to dangers.



Denotes instructions that draw your attention to special features.

◀ Denotes the end of the instruction or other text.

Subject to technical modifications.

### Installation information

Ensure that the cables/lines are not kinked or damaged as you install them in the car. The costs incurred as a result of this will not be reimbursed by BMW AG.

Additional cables/lines that you install must be secured with cable ties.

All the figures show LHD cars, proceed in exactly the same way on RHD cars.

Some of the installation of the aerial is shown only on the left-hand side of the car, proceed in the same way on the right-hand side of the car.

On cars without SA 520 the additional components not supplied in this retrofit kit (fog light wiring harness and light control unit and footwell module) must also be retrofitted.

### Ordering instructions

The following parts are not supplied in the retrofit kit and must be ordered separately (see EPC for part number and details).

- Registration plate support **O**
- Screw for registration plate support **P**
- Power unit bottom guard **CD**
- **Cars without SA 520 only**
  - Fog light wiring harness
  - Light control unit
  - Footwell module
- **Cars with SA 541 only**
  - Grille (centre) **B**

### List of special equipment (options)

The following special equipment (options) must be taken into consideration when installing the retrofit kit:

- |               |   |
|---------------|---|
| <b>SA 502</b> | Headlight cleaning system                   |
| <b>SA 507</b> | Park Distance Control (PDC), rear           |
| <b>SA 508</b> | Park Distance Control (PDC), front and rear |
| <b>SA 520</b> | Fog lights                                  |
| <b>SA 541</b> | Adaptive Cruise Control                     |

### Special tools required

None

## Contents

Section	Page
1. Front bumper parts list .....	4
2. Rear bumper parts list .....	5
3. Side skirts and underfloor trims parts list .....	6
4. Preparations.....	7
5. To install the front bumper trim .....	8
6. To install the underfloor trims and side skirts .....	10
7. To install the rear bumper trim .....	11
8. Concluding work and coding .....	12

# 1. Front bumper parts list

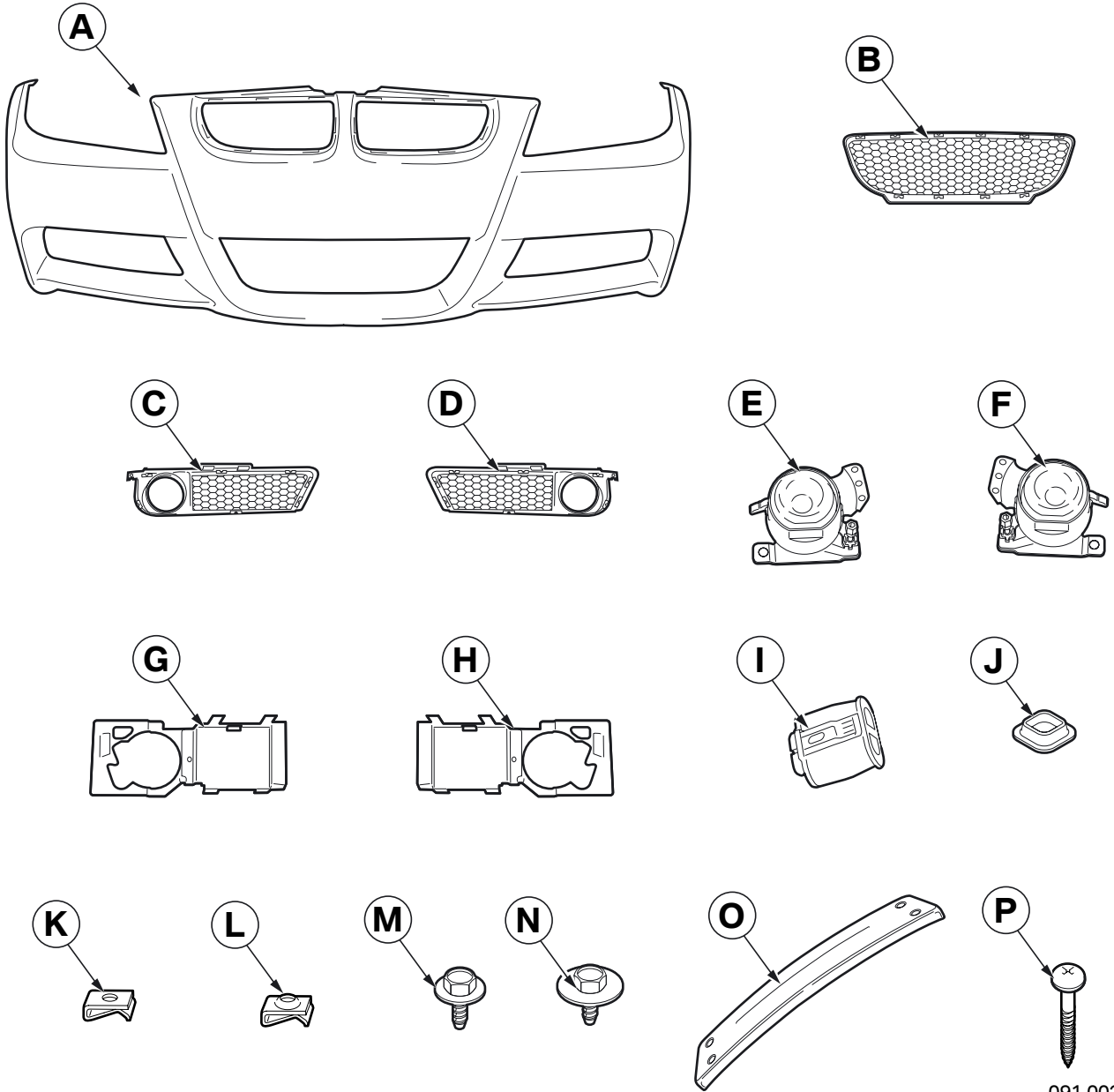

091 0022 Z

## Legend

- |   |                     |   |   |
|---|---------------------|---|---|
| A | Bumper trim (front) | I | Plug (2x)   |
| B | Grille (centre)     | J | Spacer sleeve (4x)  |
| C | Grille (left)       | K | Clip-on nut (4x)  |
| D | Grill (right)       | L | Speed nut (10x)   |
| E | Fog light (left)    | M | Self-tapping screw (10x)  |
| F | Fog light (right)   | N | Self-tapping screw (black, 9x)  |
| G | Holder (left)       | O | Registration plate support (not supplied with the retrofit kit)                         |
| H | Holder (right)      | P | Screw for registration plate support 5 x 25 mm (4x, not supplied with the retrofit kit) |

## 2. Rear bumper parts list

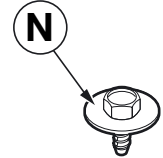
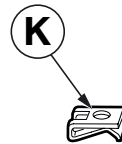
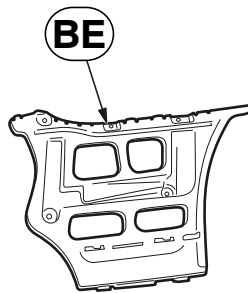
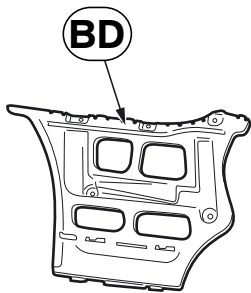
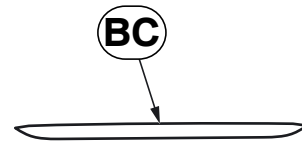
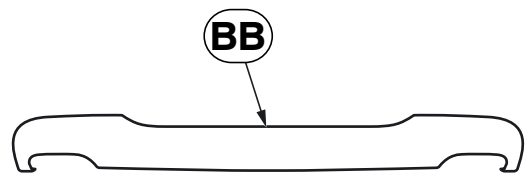
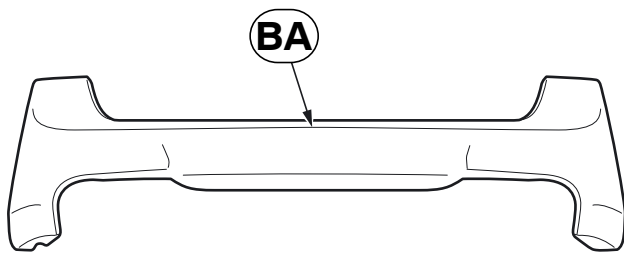

091 0023 Z

### Legend

BA Bumper trim (rear)  
BB Diffuser  
BC Trim  
BD Guide (left)

BE Guide (right)  
K Clip-on nut (2x)  
L Speed nut  
N Self-tapping screw, black (11x)

### 3. Side skirts and underfloor trims parts list

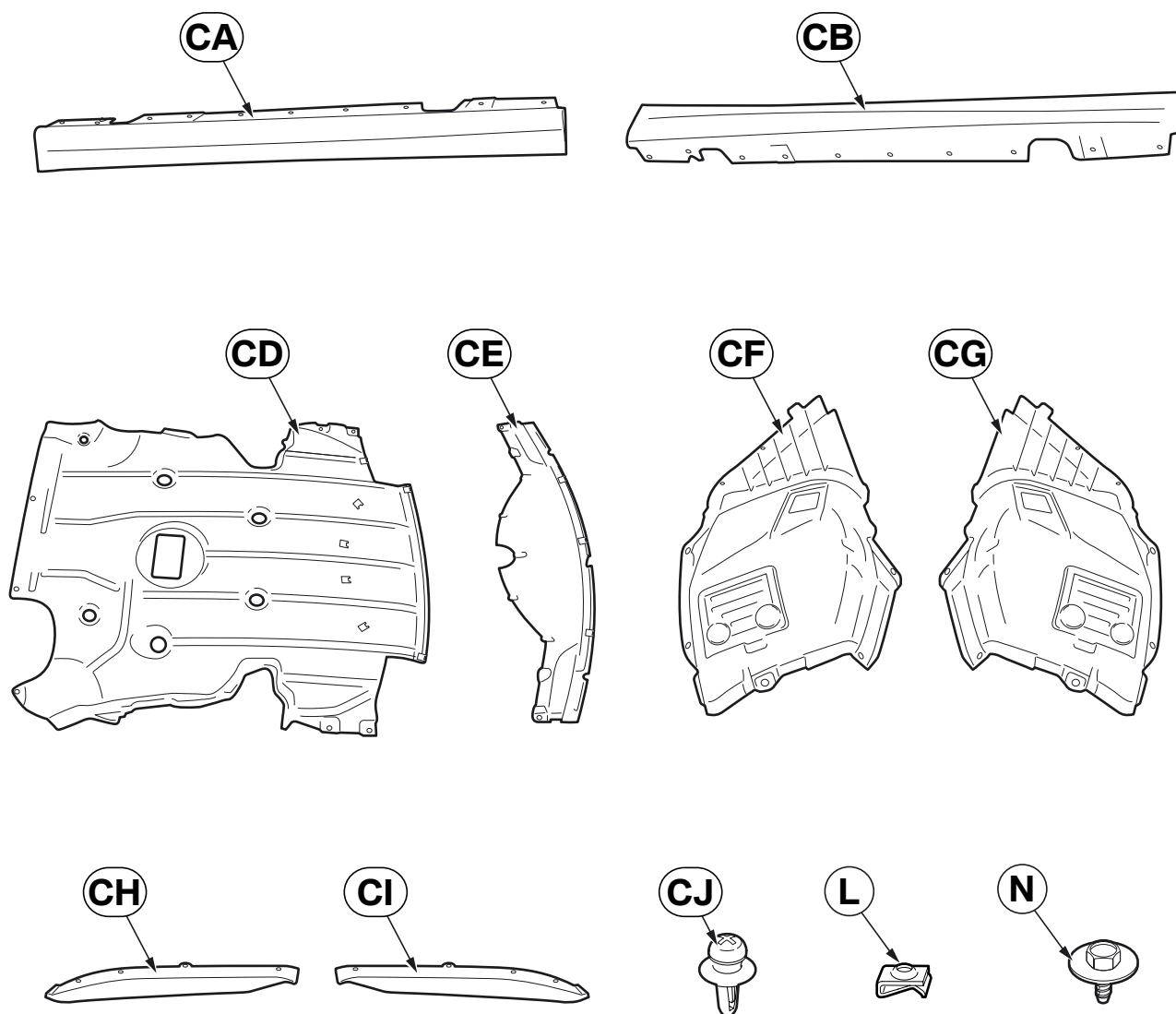

091 0024 Z

#### Legend

- |    |  |    |                                |
|----|--|----|--------------------------------|
| CA | Side skirt (left)  | CH | Ram-air lip (left)             |
| CB | Side skirt (right)   | CI | Ram-air lip (right)            |
| CD | Power unit bottom guard (not supplied with the retrofit kit) | CJ | Expanding rivet (4x)           |
| CE | Adapter  | L  | Speed nut (12x)                |
| CF | Wheel arch trim on (front left)                              | N  | Self-tapping screw (black, 9x) |
| CG | Wheel arch trim (front right)                                |    |                                |

## 4. Preparations

	<b>TIS No.</b>
Conduct a brief test	---
Disconnect the negative pole of the battery	12 00 ...
<b>The following components must be removed first of all</b>	
Front wheels, left and right	36 10 300
Power unit bottom guard (no longer required)	51 47 490
Wheel arch trim (front section), front left and right (no longer required)	51 71 038
Front bumper trim (no longer required)	51 11 156
Front ornamental grille, centre left and right	51 13 001
Insert (for front bumper trim), left and right	---
Registration plate and, if applicable, existing front registration plate support	51 11 158
Sill trims, left and right (no longer required)	51 71 447
Bumper trim, rear (no longer required)	51 12 156
Guide (for rear bumper trim), side left and right (no longer required)	51 12 828
<b>Cars with SA 507 only</b>	
Remove rear ultrasonic converters	66 20 540
<b>Cars with SA 508 only</b>	
Remove front ultrasonic converters and install them in bumper trim <b>A</b>	66 20 520
Remove rear ultrasonic converters and install them in bumper trim <b>BA</b>	66 20 540

## 5. To install the front bumper trim

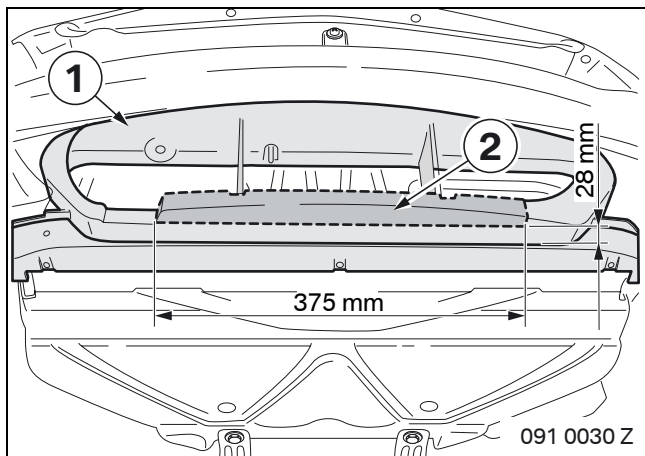

Mark the specified dimensions on the front panel (1).

Cut out the marked area (2) using a saw.

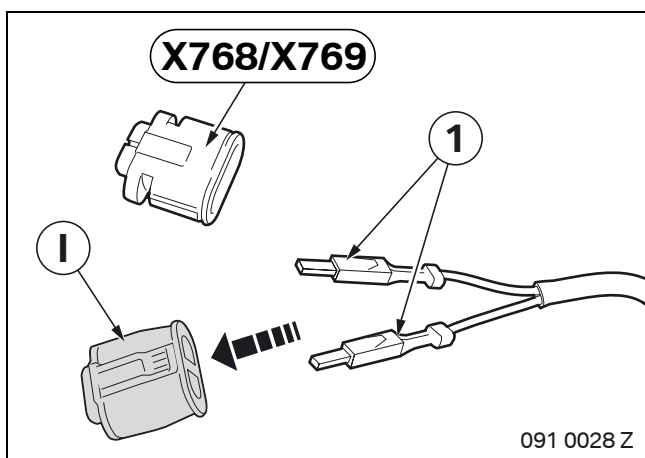

### Cars without SA 520 only

Install fog light wiring harness (see installation instructions entitled "Retrofit fog lights E90/E91").

### All cars

Disconnect the cable (1) from plugs **X768** and **X769** on the fog lights and connect them to plug **I** as follows:

- BR/GE cable to PIN 1
- BR cable to PIN 2

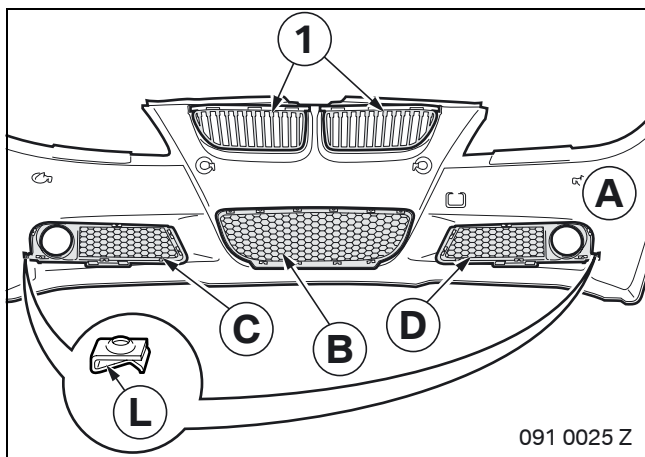

Clip the parts into bumper trim **A** as follows:

- Front centre ornamental grille (1)
- Grille (centre) **B**
- Grille (left) **C**
- Grill (right) **D**

Fit speed nuts **L** on to grilles **C** and **D**.

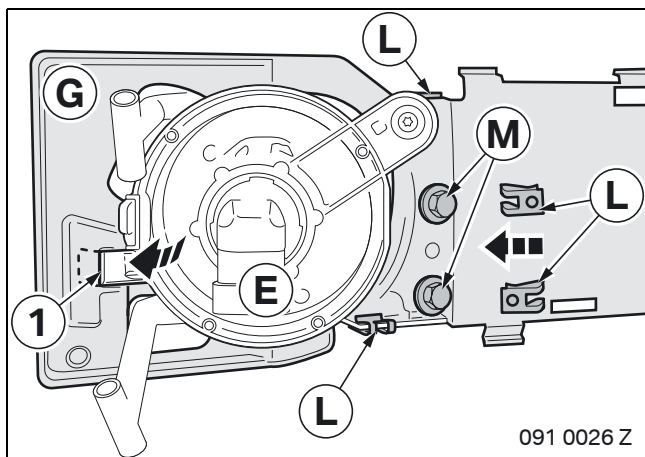

Push speed nuts **L** on to holder **G**.

Place the lug (1) from fog light **E** in holder **G**.

Secure fog light **E** using self-tapping screws **M**.

Proceed in exactly the same way on the right-hand side.

5. To install the front bumper trim

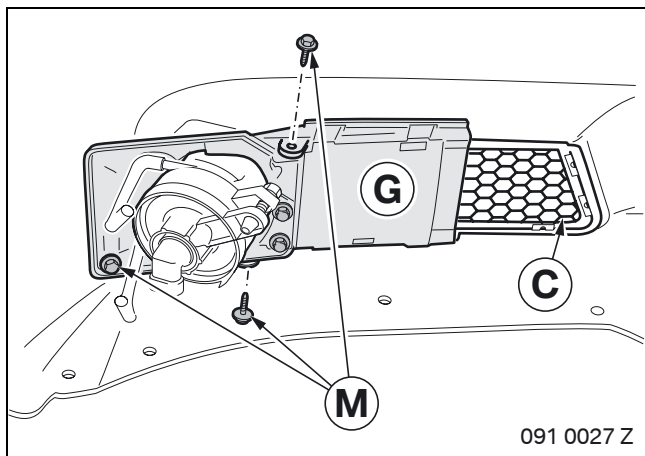

Insert holder **G** into grille **C** and lock it into place.  
Use self-tapping screws **M** to secure holder **G**.  
Proceed in exactly the same way on the right-hand side.

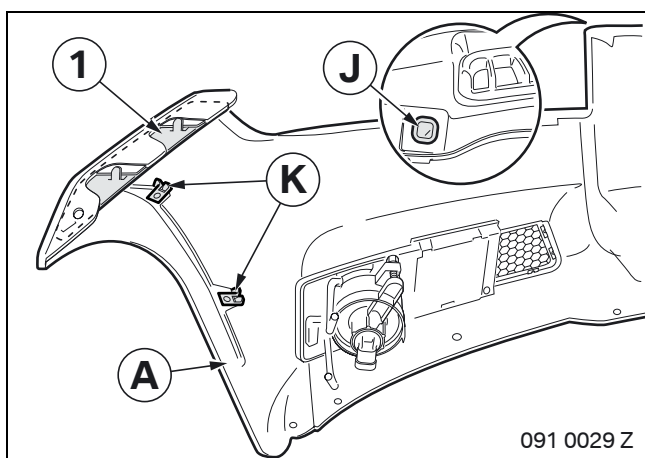

Place the parts on bumper trim **A** as follows:

- Insert (1)
- Clip-on nuts **K**
- Spacer sleeves **J**

Proceed in exactly the same way on the right-hand side.

Install bumper trim **A** as described in TIS RA 51 11 156.

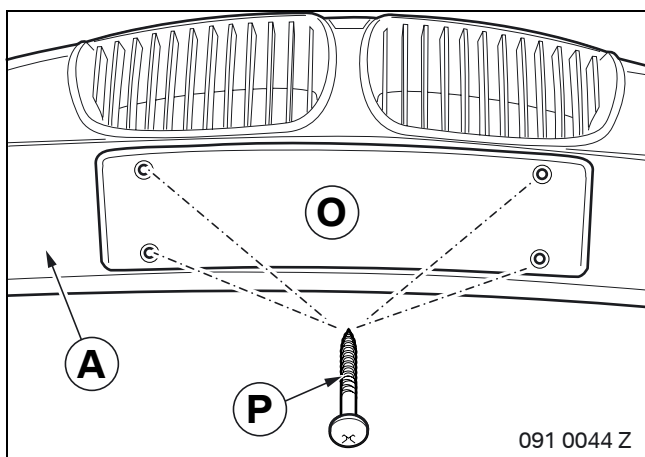

Align registration plate support **O** on bumper trim **A** and secure it with screws for registration plate support **P**.

Install the registration plate.

## 6. To install the underfloor trims and side skirts

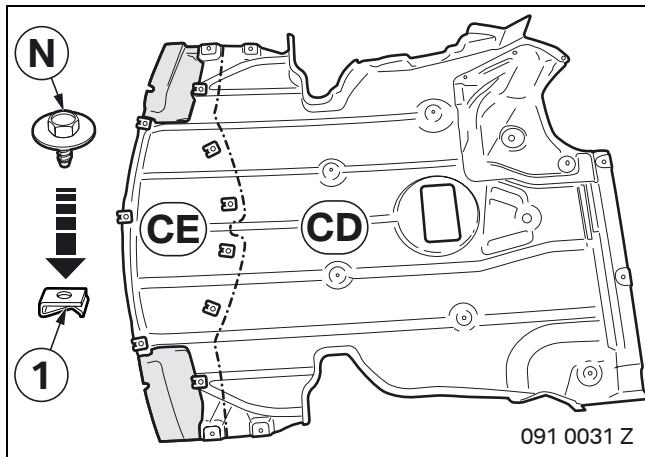

Secure adapter **CE** with self-tapping screws **N** to the speed nuts (1) on the power unit bottom guard **CD**.

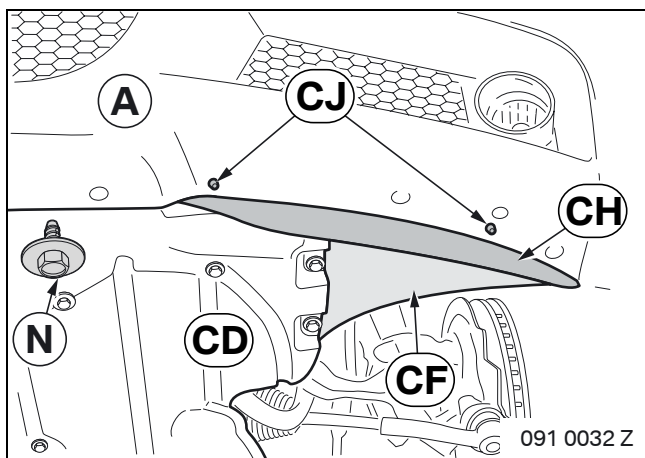

Insert wheel arch trim **CF** into the wheel arch.

Insert ram-air lip **CH** and secure it with expanding rivets **CJ**.

Proceed in exactly the same way on the right-hand side.

Secure power unit bottom guard **CD** using the existing screws.

Secure bumper trim **A** using self-tapping screws **N** to power unit bottom guard **CD**.

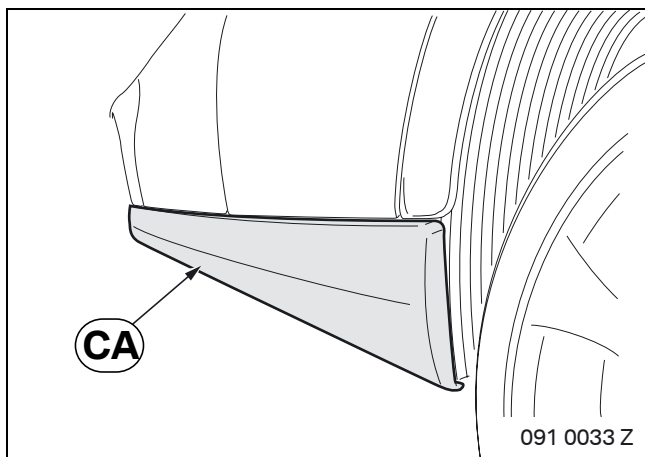

Install side skirt **CA** as described in TIS RA 51 71 447.

Proceed in exactly the same way on the right-hand side.

## 7. To install the rear bumper trim

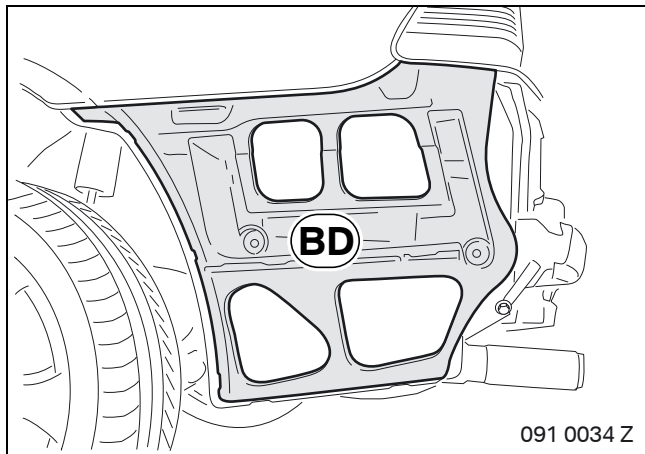

Secure left guide **BD** to the side panels using the existing screws.

Proceed in exactly the same way on the right-hand side.

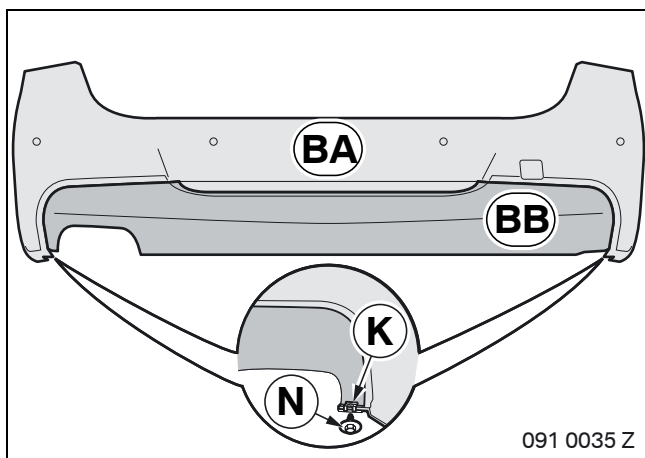

Clip diffuser **BB** into bumper trim **BA** and secure it with self-tapping screws **N** and clip-on nuts **K**.

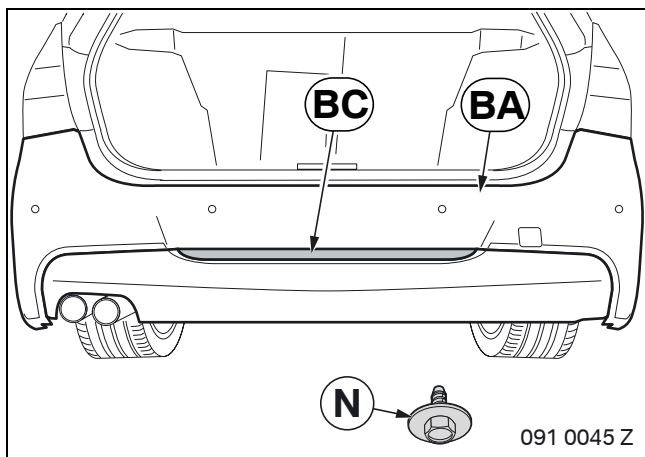

Install rear bumper trim **BA** with black self-tapping screws **N** as described in TIS RA 51 12 156.

Clean and degrease gluing surfaces.

Affix trim **BC**.

**Cars with retrofit rigid or removal towing hitch only**

Make any necessary cut-outs on bumper trim **BA** at your own discretion.

## **8. Concluding work and coding**

The retrofit system does not require encoding on cars with SA 520.

- Connect the battery
- Conduct a brief test

### **Cars without SA 520 only**

- Retrofit and encode the additional components required and not supplied in this retrofit kit (fog light wiring harness, light control unit and footwell module).

### **All cars**

- Re-assemble the car
- Adjust the fog lights as described in TIS RA 63 10 014